



1

Pneumatic - Spring	2/2 3/2	Ordering code 104.1.11.1.C.F	2/2 3/2	Pneumatic - Spring						
Lateral connections				Rear connections						
		<table border="1" style="width: 100%; border-collapse: collapse; font-size: x-small;"> <tr><td>TYPE</td></tr> <tr><td>T 22 = 2 ways 32 = 3 ways</td></tr> <tr><td>CONNECTION TYPE</td></tr> <tr><td>C L = Lateral P = Rear</td></tr> <tr><td>FUNCTION</td></tr> <tr><td>F A = Normally Open (N.O.) C = Normally Closed (N.C.)</td></tr> </table>	TYPE	T 22 = 2 ways 32 = 3 ways	CONNECTION TYPE	C L = Lateral P = Rear	FUNCTION	F A = Normally Open (N.O.) C = Normally Closed (N.C.)		
TYPE										
T 22 = 2 ways 32 = 3 ways										
CONNECTION TYPE										
C L = Lateral P = Rear										
FUNCTION										
F A = Normally Open (N.O.) C = Normally Closed (N.C.)										
Weight gr. 25 Minimum piloting pressure 2,5 bar				Weight gr. 25 Minimum piloting pressure 2,5 bar						
Operational characteristics	Fluid Filtered and lubricated air	Max working pressure 10 bar	Operating Temperature Min. -5°C Max. +50°C	Flow rate at 6 bar with Δp=1 90 NI/min	Orifice size mm 2,5	Working port size ø4 tube	Pilot port size M5			

Pneumatic - Spring	3/2	Ordering code 105.1.11.1	5/2	Pneumatic - Spring			
Lateral connections				Rear connections			
		<table border="1" style="width: 100%; border-collapse: collapse; font-size: x-small;"> <tr><td>TYPE</td></tr> <tr><td>T 32 = 3 ways 52 = 5 ways</td></tr> </table>	TYPE	T 32 = 3 ways 52 = 5 ways			
TYPE							
T 32 = 3 ways 52 = 5 ways							
Weight gr. 90 Minimum piloting pressure 2,5 bar				Weight gr. 100 Minimum piloting pressure 2,5 bar			
Operational characteristics	Fluid Filtered and lubricated air	Max working pressure 10 bar	Operating Temperature Min. -5°C Max. +70°C	Flow rate at 6 bar with Δp=1 120 NI/min	Orifice size mm 2,5	Working port size M5	Pilot port size M5

Pneumatic - Differential external	3/2	Ordering code 105.1.11.12	5/2	Pneumatic - Differential external			
Lateral connections				Rear connections			
		<table border="1" style="width: 100%; border-collapse: collapse; font-size: x-small;"> <tr><td>TYPE</td></tr> <tr><td>T 32 = 3 ways 52 = 5 ways</td></tr> </table>	TYPE	T 32 = 3 ways 52 = 5 ways			
TYPE							
T 32 = 3 ways 52 = 5 ways							
Weight gr. 110 Minimum piloting pressure 2,5 bar				Weight gr. 120 Minimum piloting pressure 2,5 bar			
Operational characteristics	Fluid Filtered and lubricated air	Max working pressure 10 bar	Operating Temperature Min. -5°C Max. +70°C	Flow rate at 6 bar with Δp=1 120 NI/min	Orifice size mm 2,5	Working port size M5	Pilot port size M5



1

Pneumatic - Pneumatic

3/2

Ordering code

105.T.11.11

TYPE

32 = 3 ways

52 = 5 ways

5/2

Pneumatic - Pneumatic

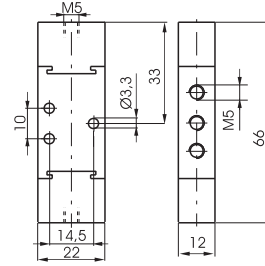
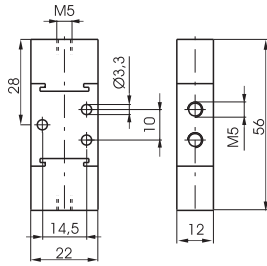

Weight gr. 110
Minimum piloting pressure 2,5 bar

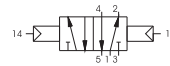
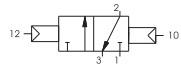

Weight gr. 120
Minimum piloting pressure 2,5 bar

Operational characteristics	Fluid	Max working pressure	Operating Temperature		Flow rate at 6 bar with $\Delta p=1$	Orifice size	Working port size	Pilot port size
	Filtered and lubricated air	10 bar	Min. -5°C	Max. +70°C	120 Nl/min	mm 2,5	M5	M5